

PARTICOLARE 3

scala 1:20

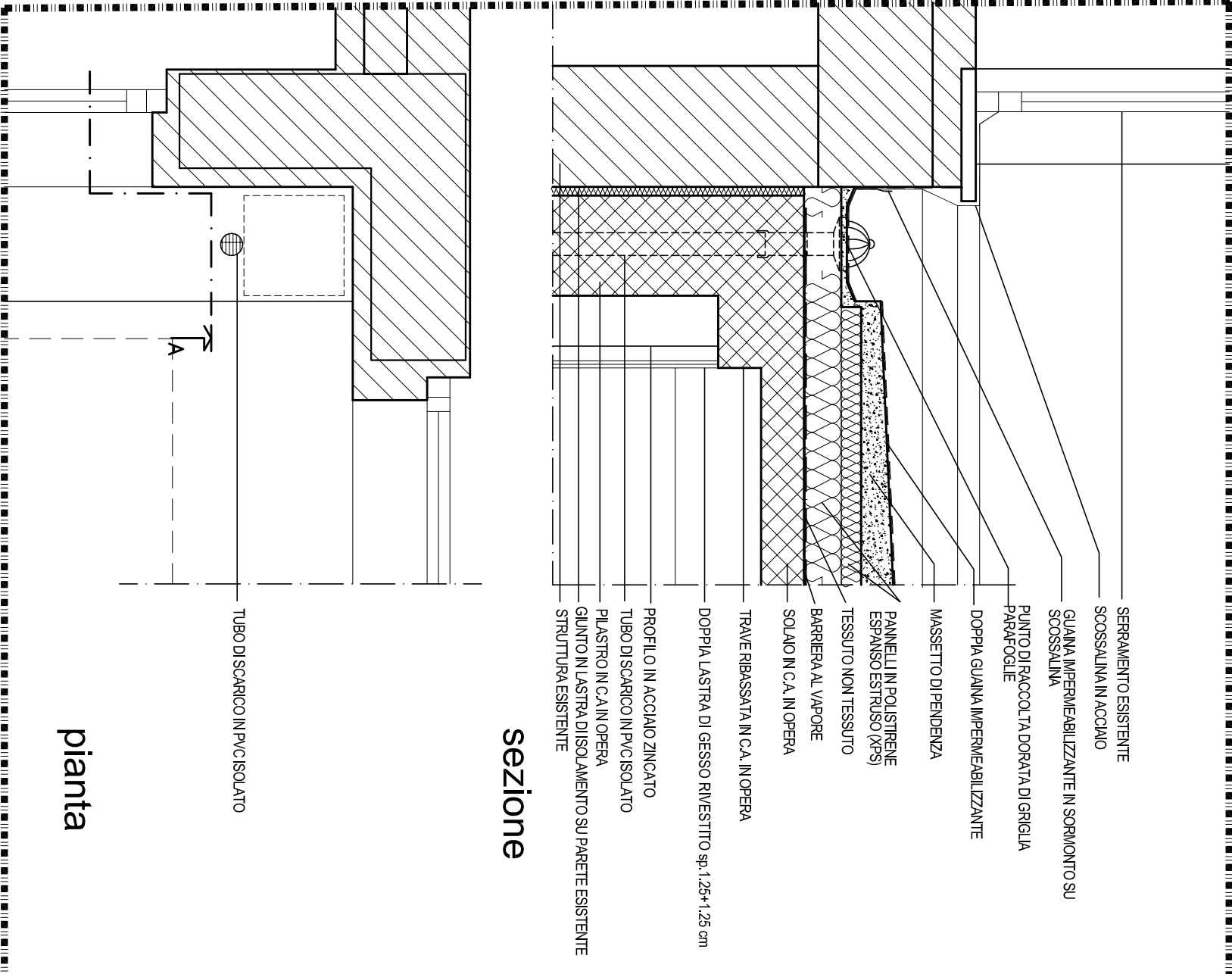

PARTICOLARE 1

scala 1:20

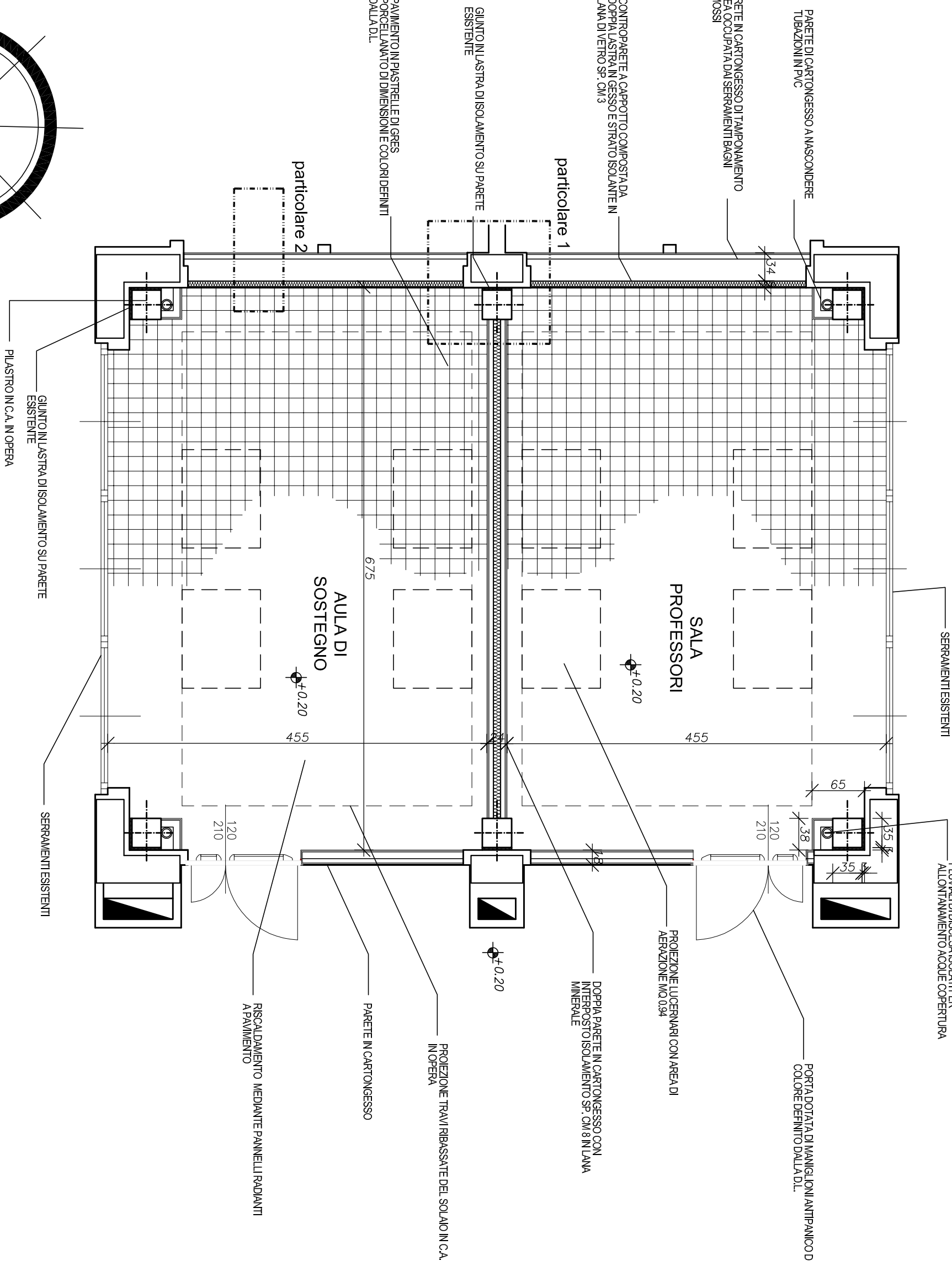
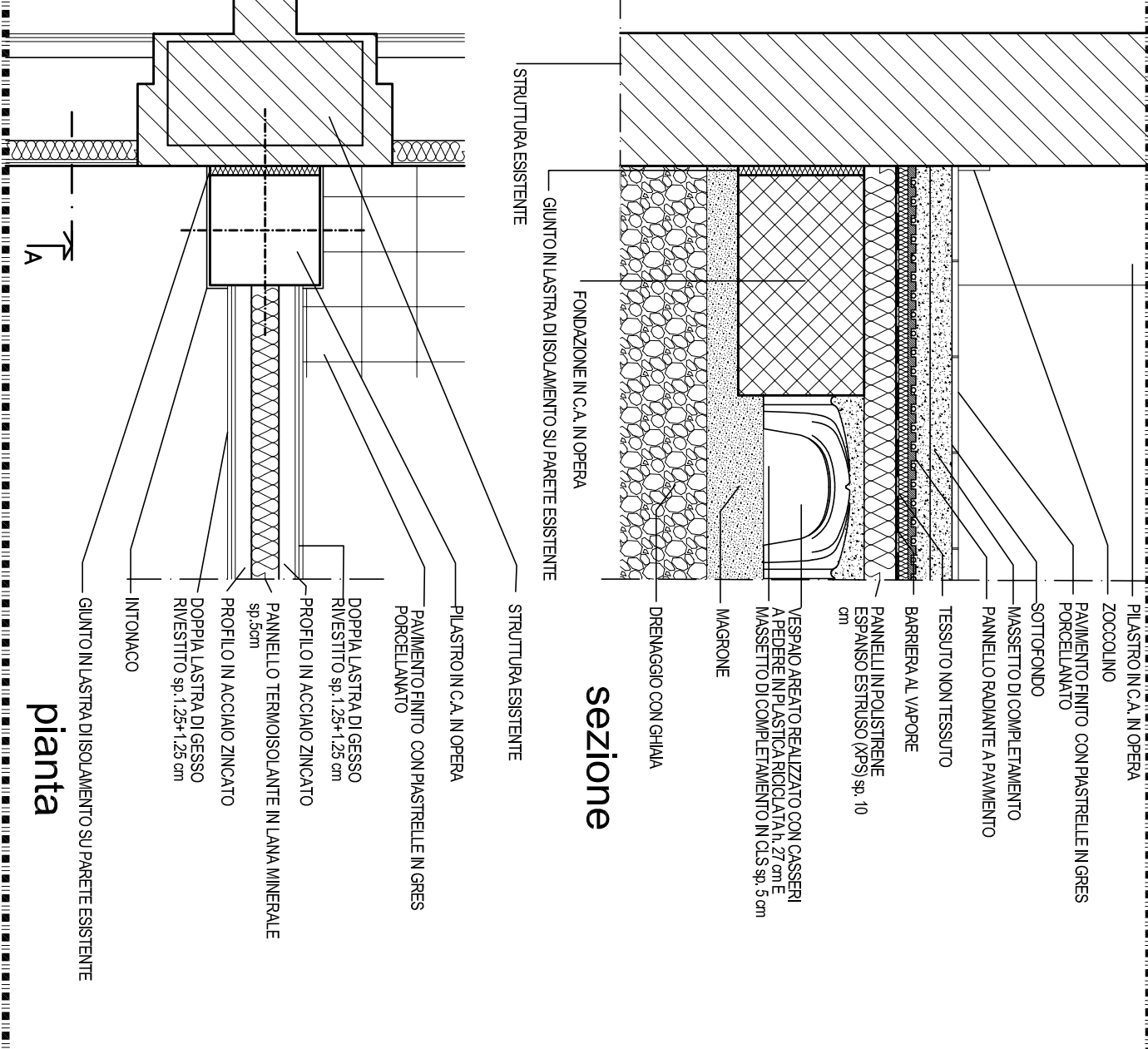

PARTICOLARE 2
scala 1:20

scala 1:20

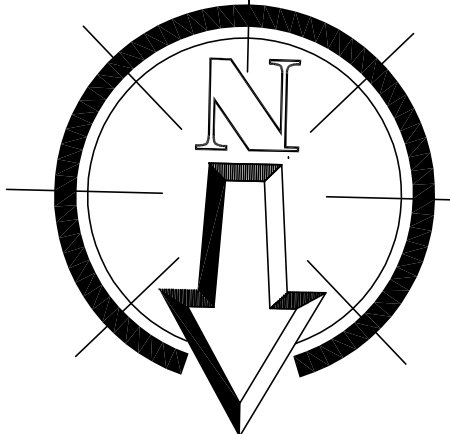
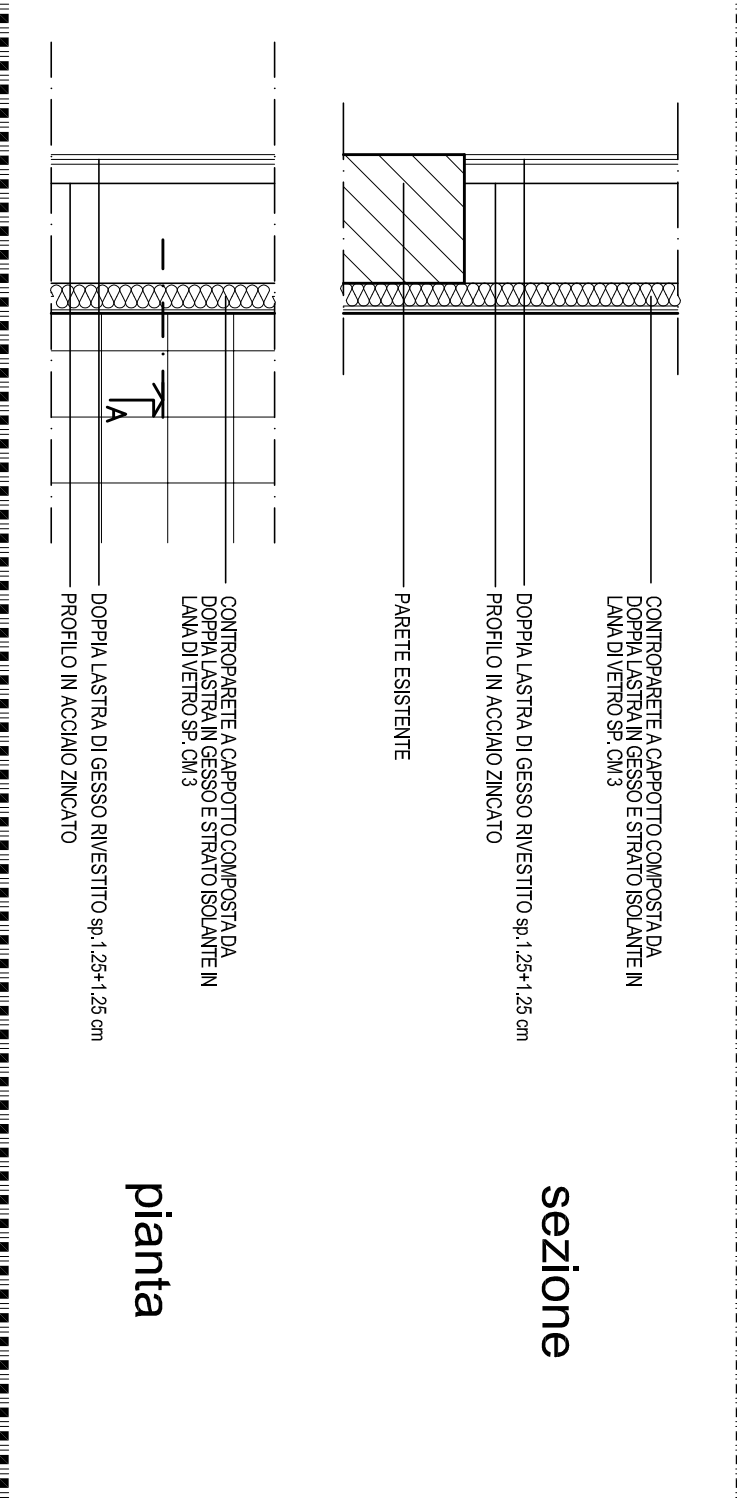

PIANTA PIANO TERRA

scala 1:50

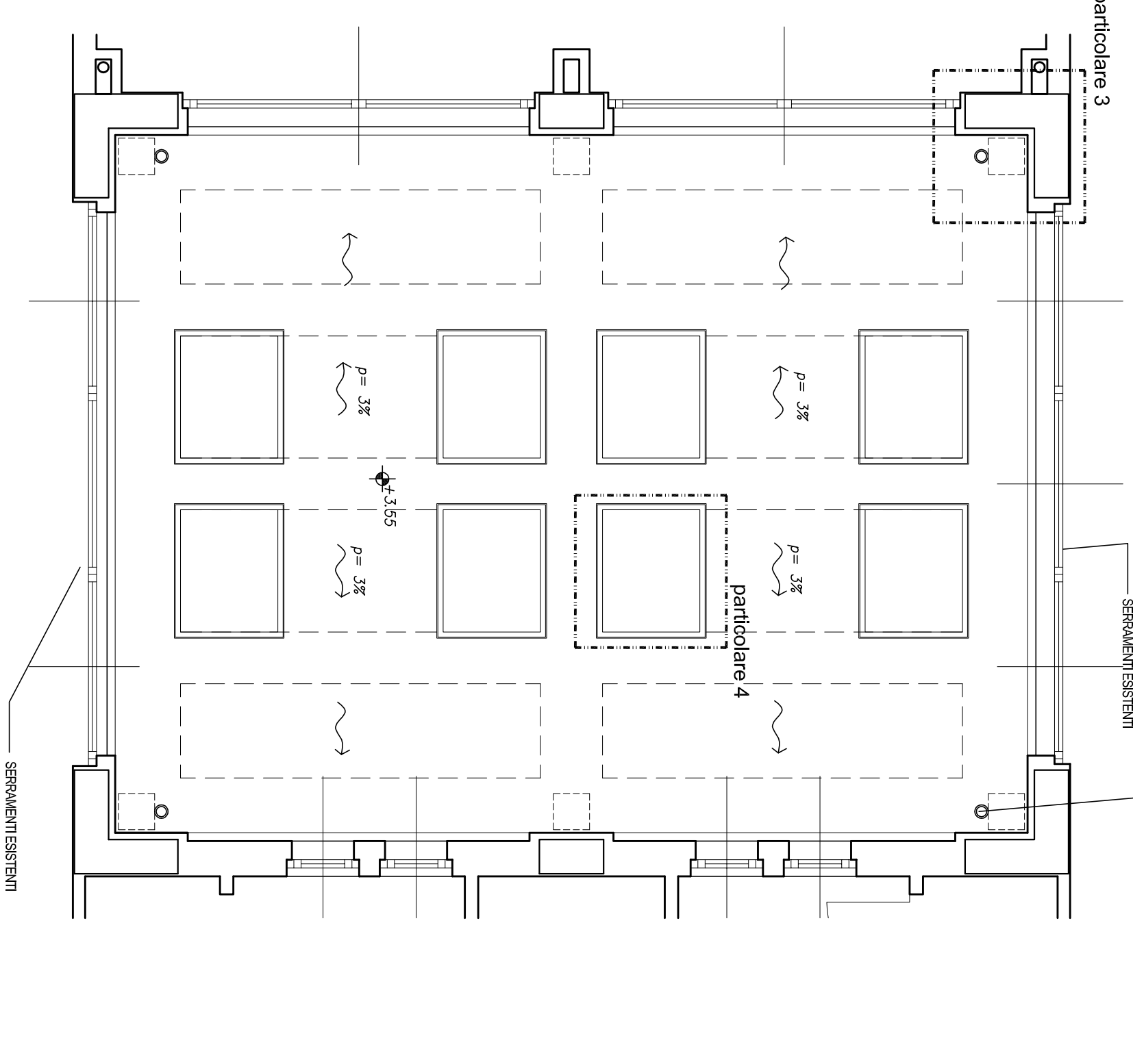

PARTICOLARE 4
scala 1:20

scala 1:20

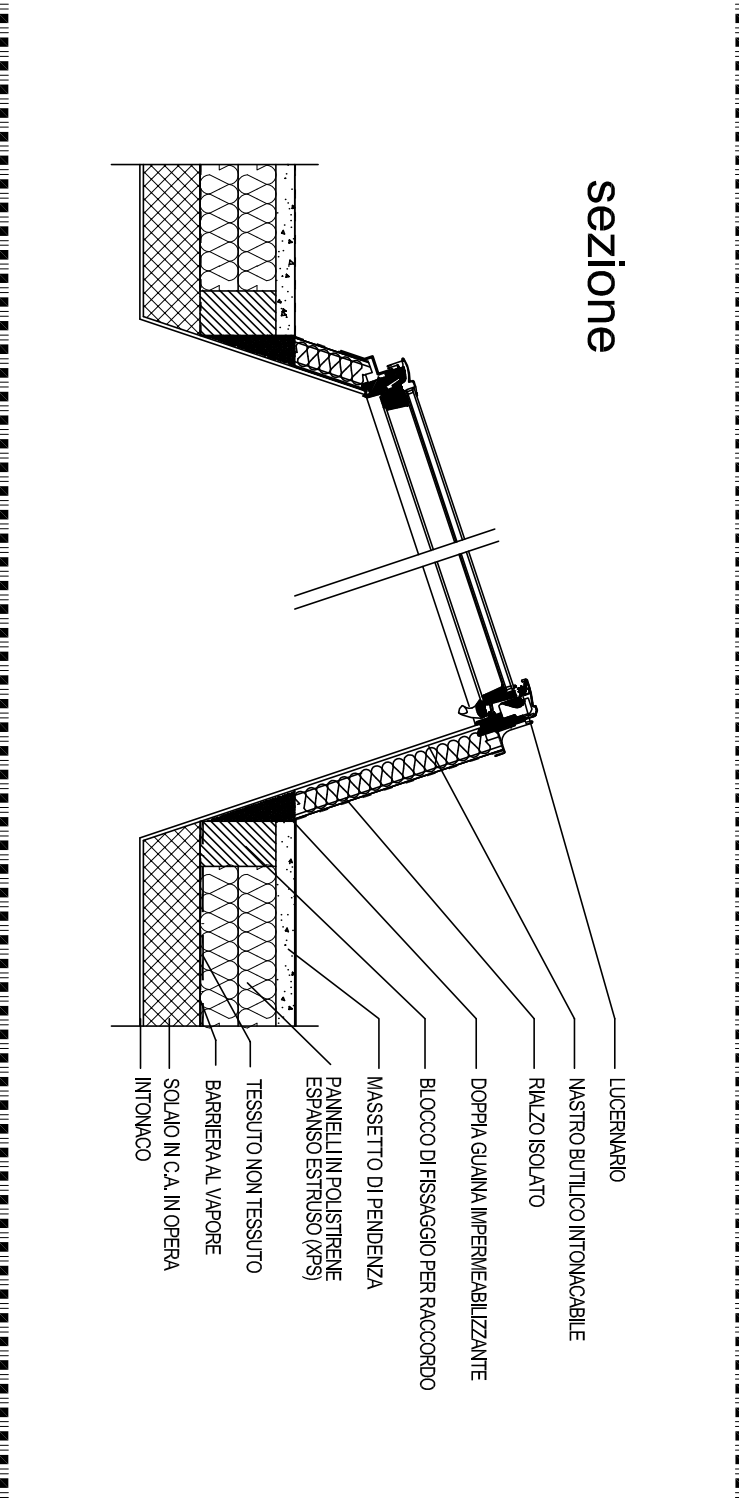

COMUNE DI TRIBIANO

Provincia di MILANO

REGIONE LOMBARDIA

Oggetto: **PROGETTO ESECUTIVO**

Ridistribuzione degli spazi interni per scuola Media e scuola Elementare

Progettista:

Ing. Benedetto Giovanni
Via Madonna del Rosario, 5
10019 - STRAMBINO - (TO)
Tel.: 0125 - 713367
E-MAIL: giovannibenedetto@gmail.com

a=

Arch. Benedetto Laura
Via Madonna del Rosario, 5
10019 - STRAMBINO - (TO)
Tel.: 0125 - 713367
E-MAIL: arch.benedetto@libero.it

Dettagli costruttivi area in ampliamento

27

OLA

data: 07/04/2015	agg:	agg:
protocollo:	Id. File: TAV_27PET.dwg	scala: 1:50 / 1:20

Committente:
Comune di Tribiano

PIANTA PIANO COPERTURA
scala 1:50